

Going home with your drain

General information

During your operation a wound drain is put in place to remove blood and tissue fluid and allow good healing.

Most patients are ready to be discharged home with their drain in place within 24 hours of their operation.

The drain will then be managed by your Breast Clinical Nurse Specialist and removed at a follow up appointment in the Breast Unit (Department B3). The Breast Clinical Nurse Specialist will make this appointment directly with you.

Recovery at home

Going home with a drain in place allows you to leave hospital earlier. You can then benefit from the comfort of your own home and support from your family and friends.

The wound drain is easy to care for at home. Most patients feel capable of looking after the drain when their Breast Clinical Nurse Specialist has discussed the care instructions as given below.

Measuring and emptying the drain

You should measure the fluid in the drain bag at the same time each day.

1. Wash your hands
2. Close the top clamp
3. Open the bottom clamp
4. Squeeze the bulb to allow the fluid to run into the bag
5. Return both clamps to their original position.
6. Measure how much fluid is in the bag using the markings on the front of the bag and write this down with the date.
7. Empty the fluid down the toilet by pushing the white clip at the bottom of the bag across and then push back to its closed position.

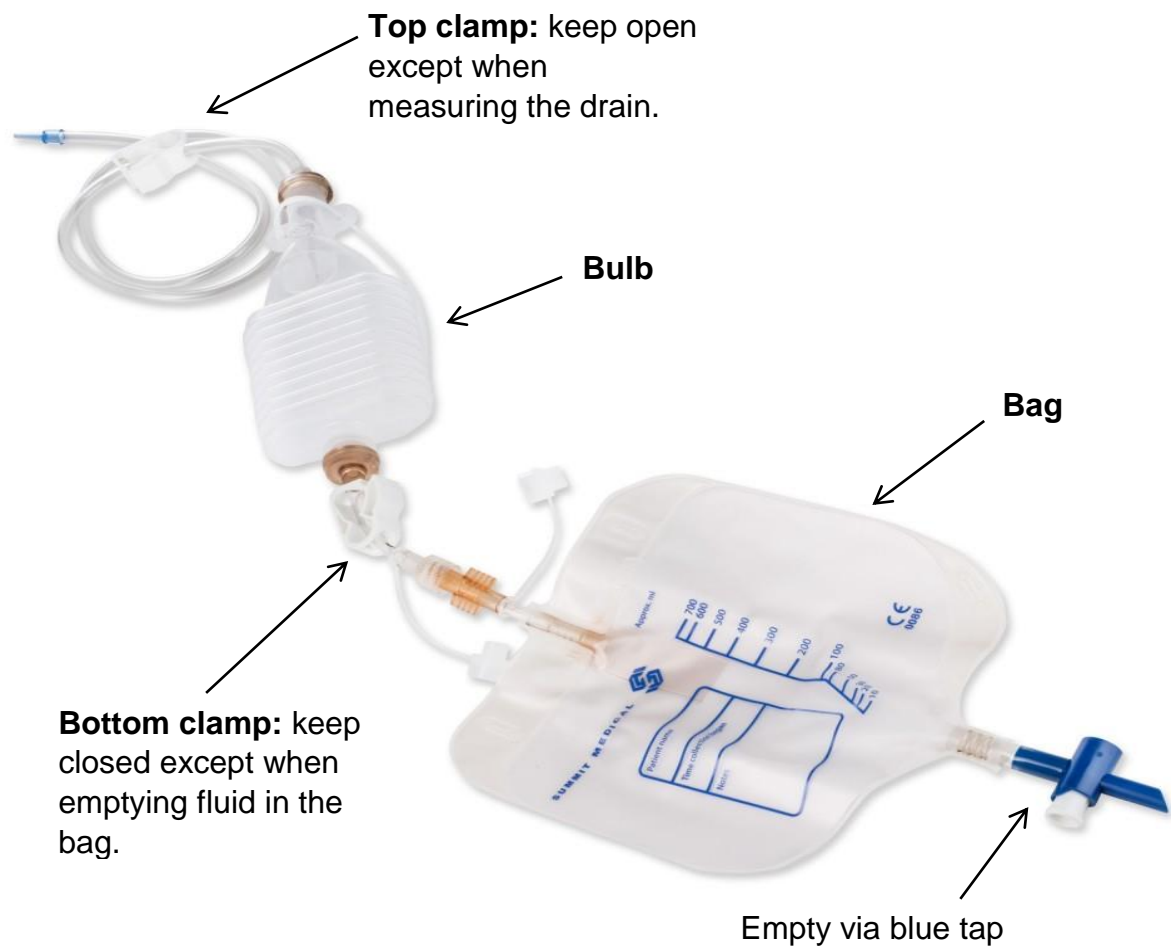

If you have any concerns at all please contact your Breast Clinical Nurse Specialist (Monday to Friday 8am – 6pm) on 01225 824057 or outside these times, Charlotte Ward(D9) on 01225 824434 or 01225 821082.

Royal United Hospitals Bath NHS Foundation Trust
Combe Park, Bath BA1 3NG
01225 428331 www.ruh.nhs.uk

Please contact the Patient Advice and Liaison Service (PALS) if you require this leaflet in a different format, or would like to feedback your experience of the hospital. Email ruh-tr.pals@nhs.net or telephone 01225 825656 or 826319.